

OAKLAND-WIDE COMMUNITY MEETING

MARCH 30, 2021

Jobs & Financial
Coaching



Youth



Community
Land Trust



Neighborhood
Quality



Affordable
Housing



OPDC

Oakland Planning
and Development
Corporation

AGENDA

- OPDC and community updates and announcements
- **Carnegie Mellon University** – introduction to the process of a new 10-year Institutional Master Plan

FRAZIER NORTH, OAKLAND CLT, JOB and FINANCIAL COACHING, ADOPT-A-BLOCK

- OPDC will present **Frazier North Residences** to the South Oakland Neighborhood Group (SONG) meeting on April 6. Frazier North will include four new-construction affordable homes for sale as part of the Oakland CLT. More details at www.bit.ly/fraziernorth
- Our **Community Land Trust Aging in Place** program now accepts applications from residents 55 and older. Eligible homeowners can receive up to \$22,500 for home repairs. Learn more at www.opdc.org/clt
- OPDC continues to offer FREE **job and financial coaching** over the phone or Zoom. We can help with employment coaching, resume assistance, creating savings goals, reducing debt, and more. Coaching is confidential and one-on-one. Contact Camille Dixon at cdixon@opdc.org or 412.621.7863 x212 to get started.
- Volunteer with OPDC at our next **Adopt-a-Block** litter cleanup on Saturday, April 17, from 10:00 a.m. until 11:30 a.m. We'll provide gloves and other supplies. Visit www.opdc.org/events for more information or to register.

OAKLAND FOOD DISTRIBUTION

- **Food Distribution** continues throughout Oakland. Organizations/locations include:
 - Community Human Services (CHS) Food Pantry – Thursdays: 3 – 6 PM and Fridays: 11 AM – 2 PM
 - Frazier Field House – Tuesdays and Thursdays: 3 – 5 PM
 - Islamic Center of Pittsburgh – Third Saturday of each month: 10:30 AM – 2 PM
 - St. George Cathedral – Third Saturday of each month: 10 AM – 12:30 PM
 - University of Pittsburgh Pitt Pantry – Wednesdays: 3 – 7 PM and Fridays: 1 – 5PM

Visit www.opdc.org/neighborhoodquality for more information.

NEW RECYCLING BINS AND PRESERVATION PITTSBURGH LECTURE

NEW BLUE BIN ROLLOUT

PITTSBURGH CURBSIDE RECYCLING



INFORMATION: pittsburghpa.gov • 311 Response Center 412-255-2621 • Twitter @Pgh311

The City of Pittsburgh will deliver new recycling bins to Oakland residents this spring.

They are currently hosting educational webinars with the latest updates on recyclable items. The next webinar is on April 6. Learn more at

www.pittsburghpa.gov

Preservation Pittsburgh's Virtual Lecture Series focuses on the historic Herron Hill Pumping Station on April 15 at 6:30 p.m.

Register for FREE at www.bit.ly/ppherron



Preservation Pittsburgh presents

Landmark Lectures: People & Place

April 15, 2021 | 6:30 p.m. EST

Herron Hill Pumping Station

Jeff Slack, AICP, Principal of
Time & Place Preservation Services

*Presented in collaboration with the
Bellefield Area Citizens Association (BACA)*

OPDC

Oakland Planning
and Development
Corporation

DESIGN DEVELOPMENT REVIEW UPDATES

- The proposal for **six new townhomes on Boundary Street at Yarrow Way** goes before the Zoning Board of Adjustment (ZBA) on Thursday, April 8 at 9:50 a.m. Visit www.bit.ly/boundaryyarrow for OPDC's testimony letter and a link to the ZBA meeting.
- The **University of Pittsburgh** returned for the third (of four) IMP briefings to the City of Pittsburgh's Planning Commission last week. Pitt's final briefing takes place on April 6, and their commission hearing is scheduled for April 20. We will post our testimony letter to the project page at www.bit.ly/PittIMP by April 9, 2021.

RESIDENTIAL PARKING PERMIT PROGRAM



The **Department of City Planning** created a survey covering the designation of new districts, fees, and permits for residents and visitors. The survey, available at www.engage.pittsburghpa.gov/rpp-program-updates (or by calling 311) is open until 4/25.

2022 INSTITUTIONAL MASTER PLAN



March 2021

2012 INST. MASTER PLAN



2012 IMP PROJECTS

PROJECTS
COMPLETED
/UNDERWAY





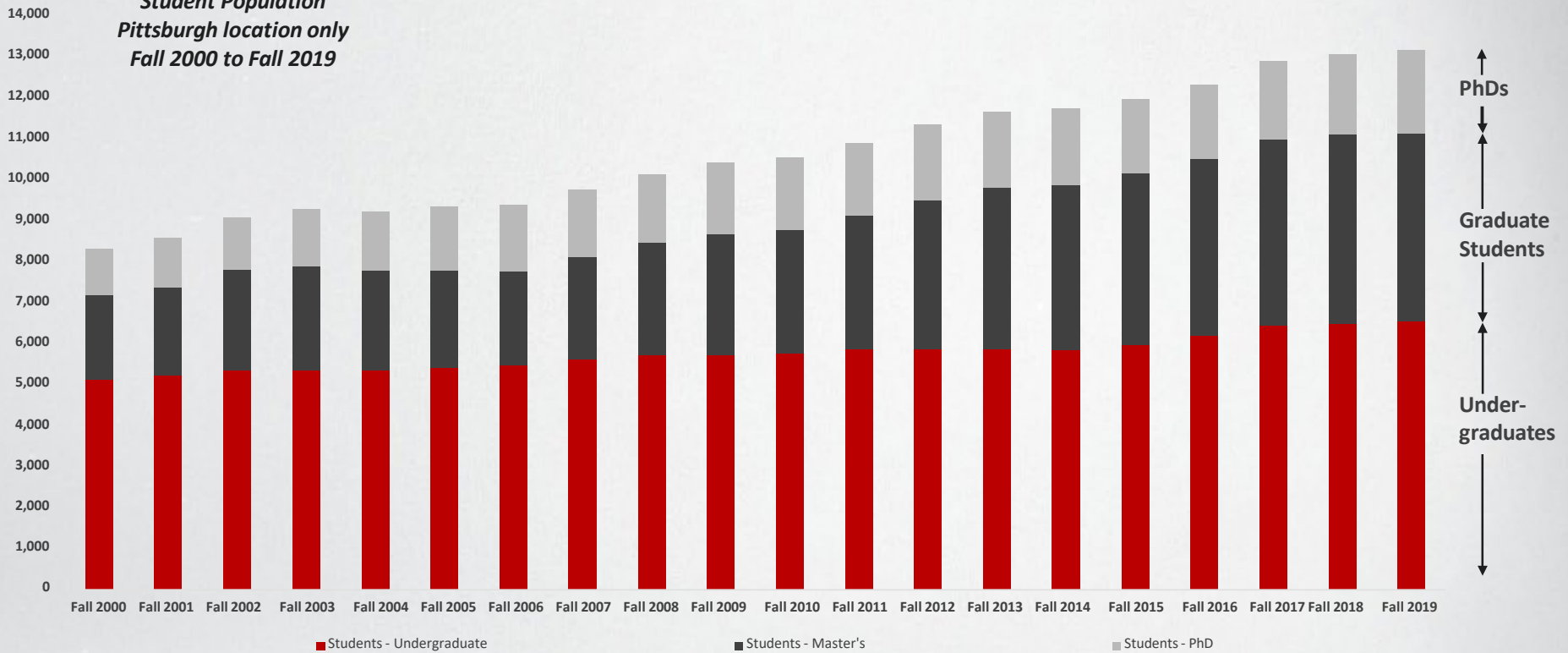

Projects
Completed/Underway
under 2012IMP

STUDENT POPULATION TRENDS

*Student Population
Pittsburgh location only
Fall 2000 to Fall 2019*



CMU IN PITTSBURGH

-  Main Campus
-  Academic
-  Research
-  Administration
-  Mixed Use



SIMONDS PRINCIPLES

BUILDING

Architecture
Safety & Security
Sustainability

SPACE

Edges, Entrances & Connections
Open Space
Public Art

COMMUNITY CONTEXT

Mixed Use
Neighborhood Compatibility

MOVEMENT

Multi-Modal Transportation
Universal Access

SUSTAINABILITY

<p>WORLD</p> <p>Commitment to 2030 United Nations SDG</p> <p>Completion of Voluntary University Review</p> 	<p>CITY</p> <p>Founding partner of 2030 District Expansion to Oakland</p> <p>Exceeding several 2030 District goals</p> 
<p>PEER INSTITUTIONS</p> <p>Outperforming 12 benchmarked peer institutions in similar climate bands</p> <p>AASHE Stars Gold</p> 	<p>UNIVERSITY</p> <p>2021 Utilities Master Plan</p> <p>Simonds Principles</p> <p>1.35M+ SF LEED-certified buildings</p> 

2022 MASTER PLAN PRINCIPLES

DESIGN

Reinforce the Connection of Design and Values
Create an Enduring Framework of Campus Spaces
Develop Campus Buildings that are Timeless

EXPERIENCE

Create Memorable Campus Gateways
Encourage Collaboration Everywhere
Foster a Lively On-Campus Lifestyle

MOBILITY

Expand and Integrate Campus Connections
Pedestrians>Bikes>Transit>Shared>Single Vehicles

CONTEXT

Nurture S Craig Street as a Great College Street
Enhance Connections to the City & Schenley Park

OPPORTUNITY

Utilize Assets for Campus Growth
Create a Campus that can Respond to a Dynamic Future

2022 MASTER PLAN THEMES

- Enhance the campus experience and develop additional academic sites in the Historic Core
- Build on the Tepper Quad to increase density in the North Campus and integrate the campus
- Support the urban framework of the Craig St area and connect it to campus
- Connect to Schenley Park and improve the Frew, Tech and M. Morrison Corridor

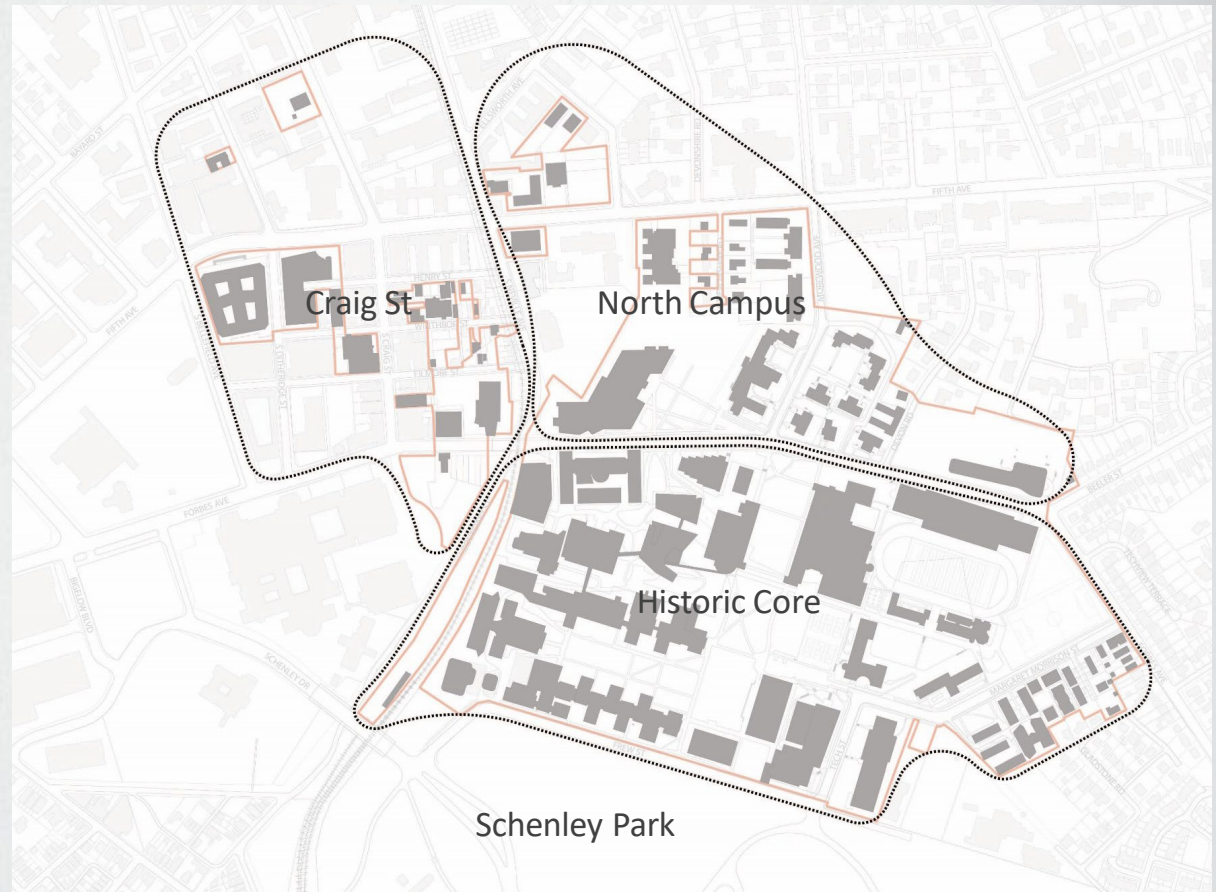

DEVELOP NEW ACADEMIC SITES ON THE HISTORIC CORE

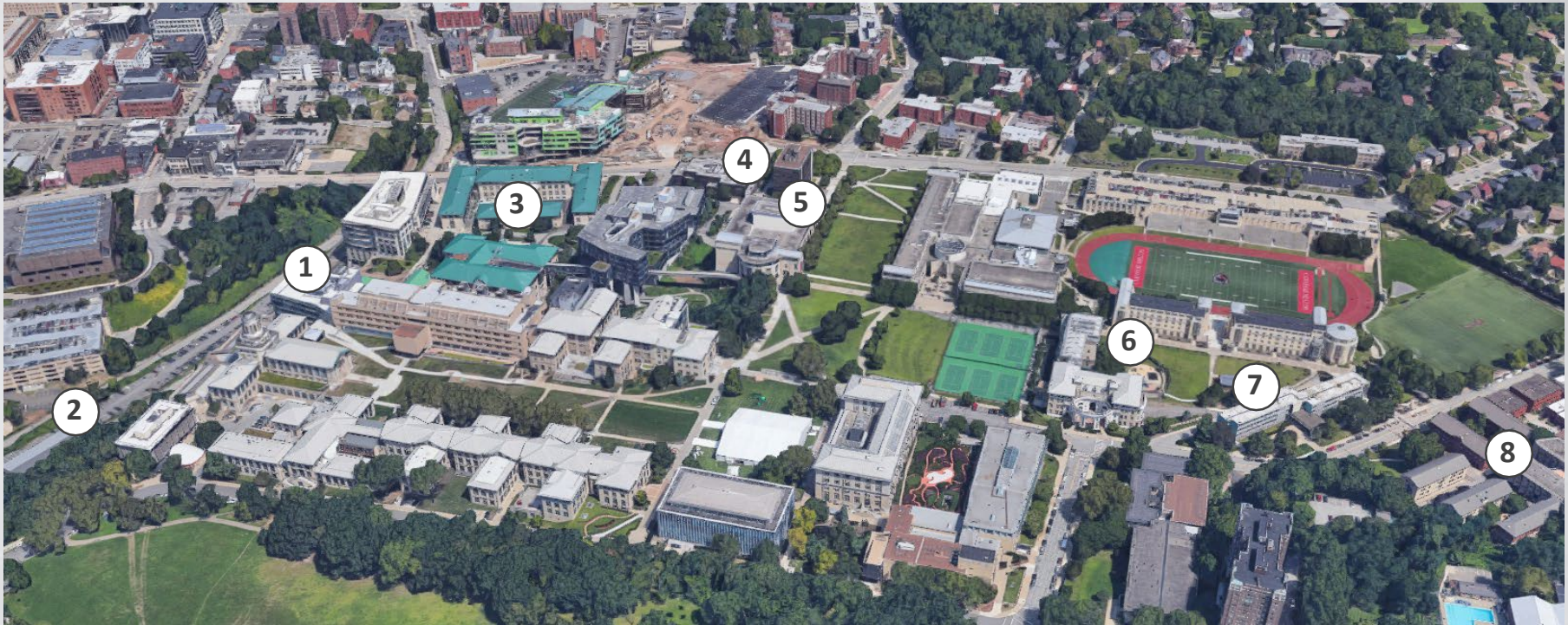

- 1 New building at FMS site
- 2 Move FMCS to S Neville
- 3 Hamburg atrium expansion

- 4 New building at Warner/Cyert
- 5 Purnell Expansion

- 6 M. Morrison Extension
- 7 New building(s) at Donner
- 8 Hamerschlag Commons

INCREASE DENSITY ON THE NORTH CAMPUS



1 Tepper Expansion

2 New Morewood building

3 E Tower Commons

4 New mixed-use building

5 Reconfigured housings quad with additional density

6 New housing building

STRENGTHEN CAMPUS CONNECTIONS



Widen Sidewalk on Forbes Ave Bridge



Widen and Separate Sidewalk on Fifth Ave

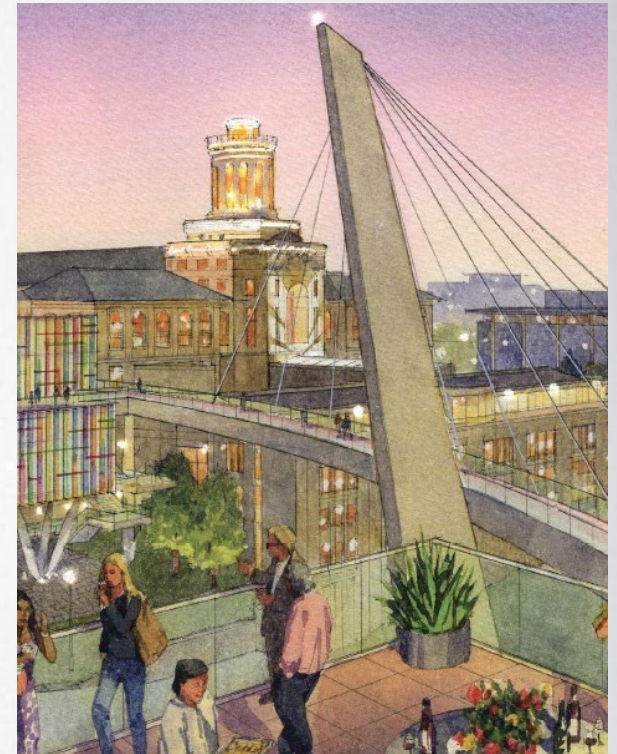

New Ped Bridge from S Craig to the Mall
as part of Science@CMU project

STRENGTHEN CAMPUS CONNECTIONS

- 1 Widen sidewalk on Forbes Ave B ridge
- 2 Widen and separate sidewalks on Fifth Ave
- 3 New Ped/Bike Bridge from S. Craig/Forbesto Scott Hall
- 4 New Ped connection to W QED & Central Catholic

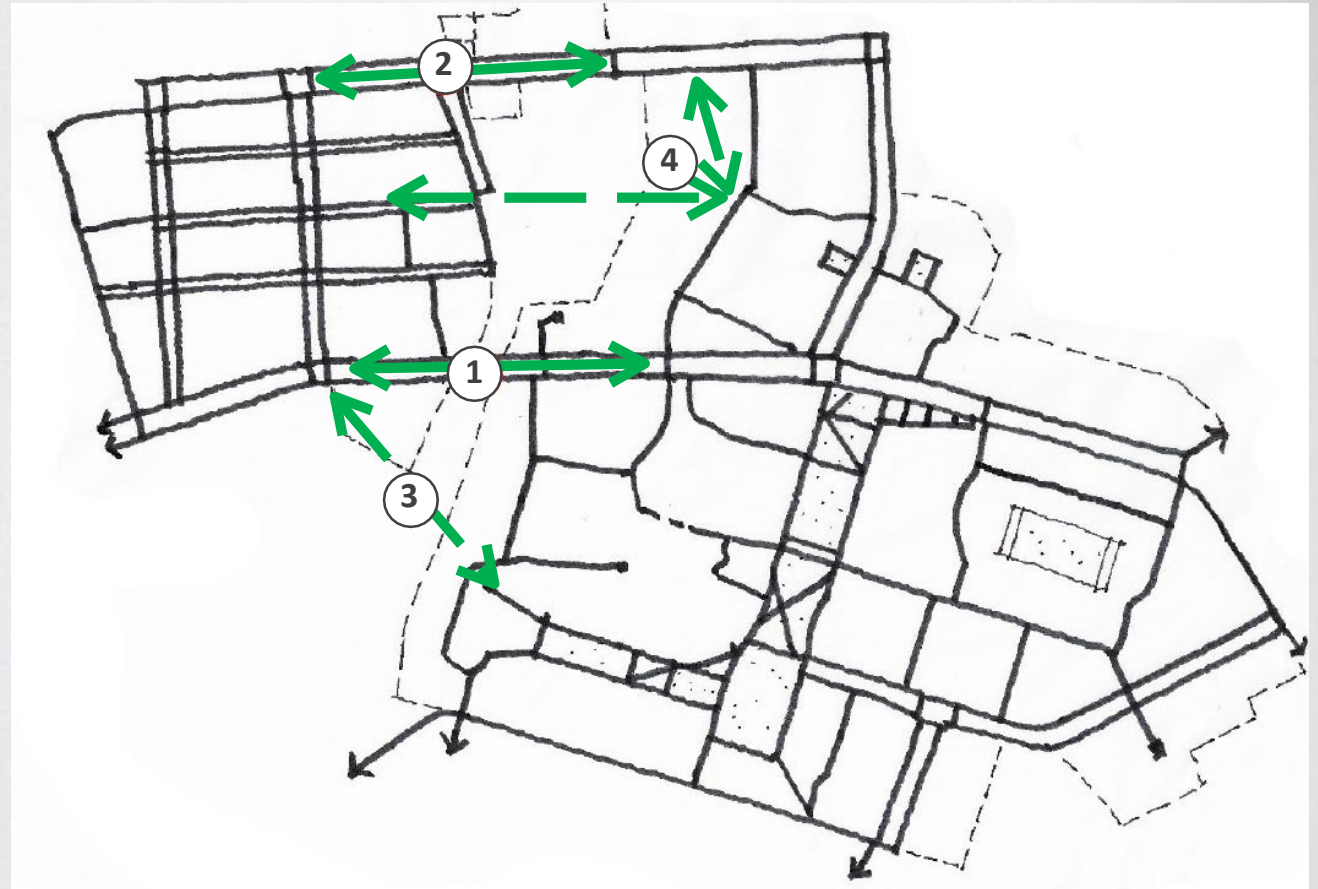

CREATE A FRAMEWORK FOR CRAIG ST AREA DEVELOPMENT

- 1 Improve connections to Mellon Inst
- 2 Activate sidewalks and public spaces with dining
- 3 Create courtyard dining opportunities
- 4 New academic building
- 5 Linear open space

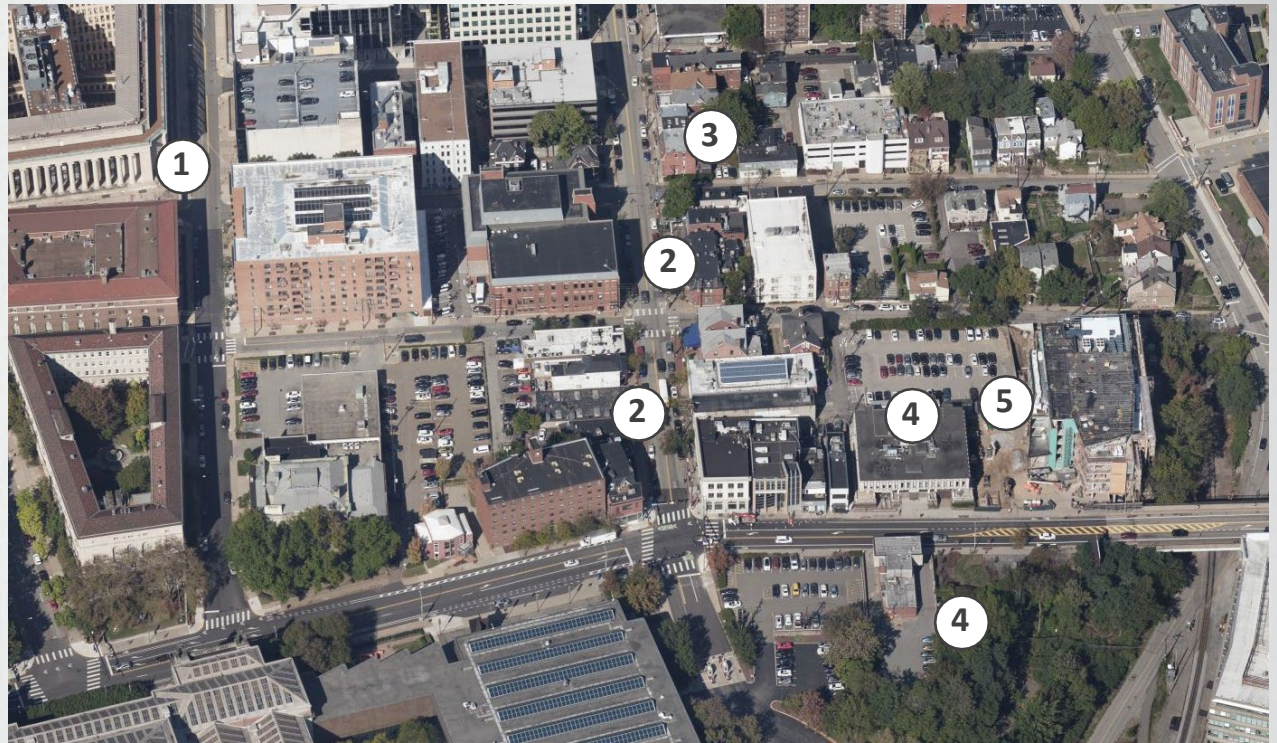

MAKE CRAIG A GREAT COLLEGE STREET



Sidewalks too narrow for outdoor seating



Create "Park-lets" for wider sidewalks



Blank walls along sidewalks



Activate and "Open-up" Ground Floors

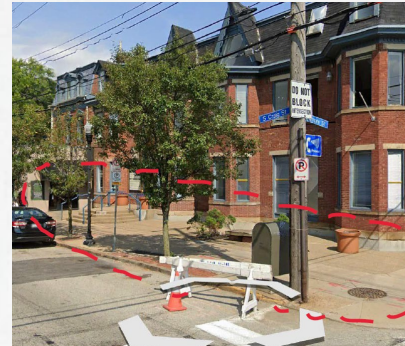

Unused open spaces



Utilize public spaces for dining



Rear and side yards that have no functions



Create off-street courtyards for dining

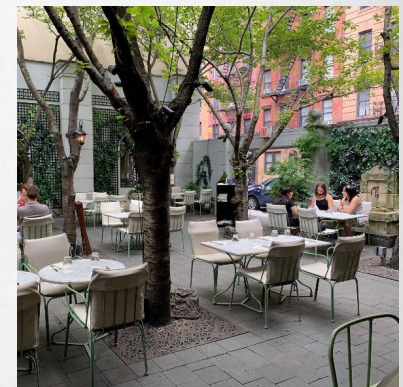

UPGRADE MOBILITY ON MOREWOOD AVE

- 1 New Bus Rapid Transit Station
- 2 Re-aligned Fifth/Morewood intersection
- 3 Sidewalk relocated closer to residences
- 4 Two-way bike track between Fifth & Forbes
- 5 Roundabout entrance to Morewood lot

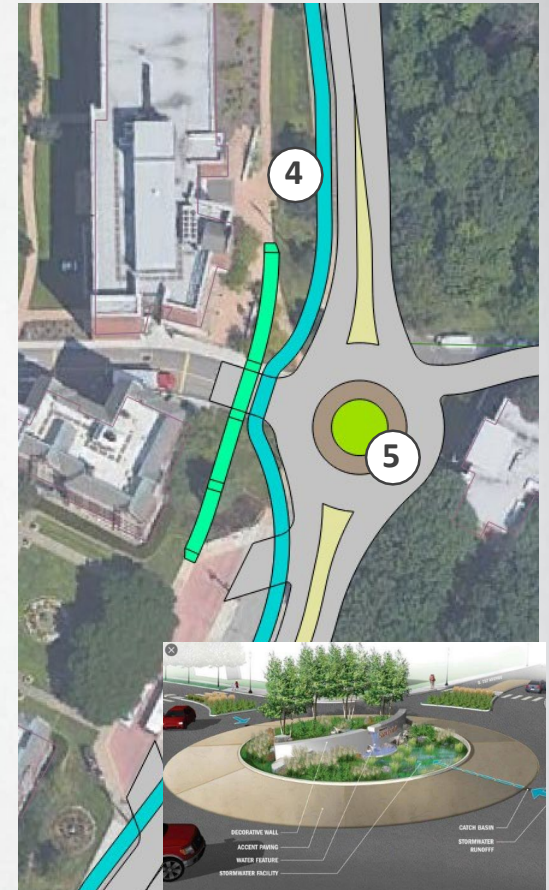
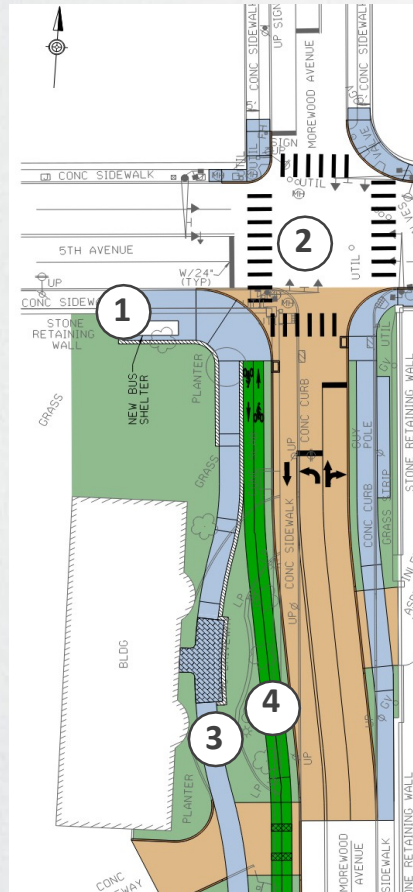

ENHANCE THE CAMPUS EXPERIENCE

- 1 Bike track connection to Fifth Ave on Morewood
- 2 Bus Rapid Transit station
- 3 Bike track and seating upgrades on The Cut
- 4 Enhanced Beach with accessible paths
- 5 Reimagined CFA lot with Plaza and Short Term Parking
- 6 Entrance Plaza to Schenley Park

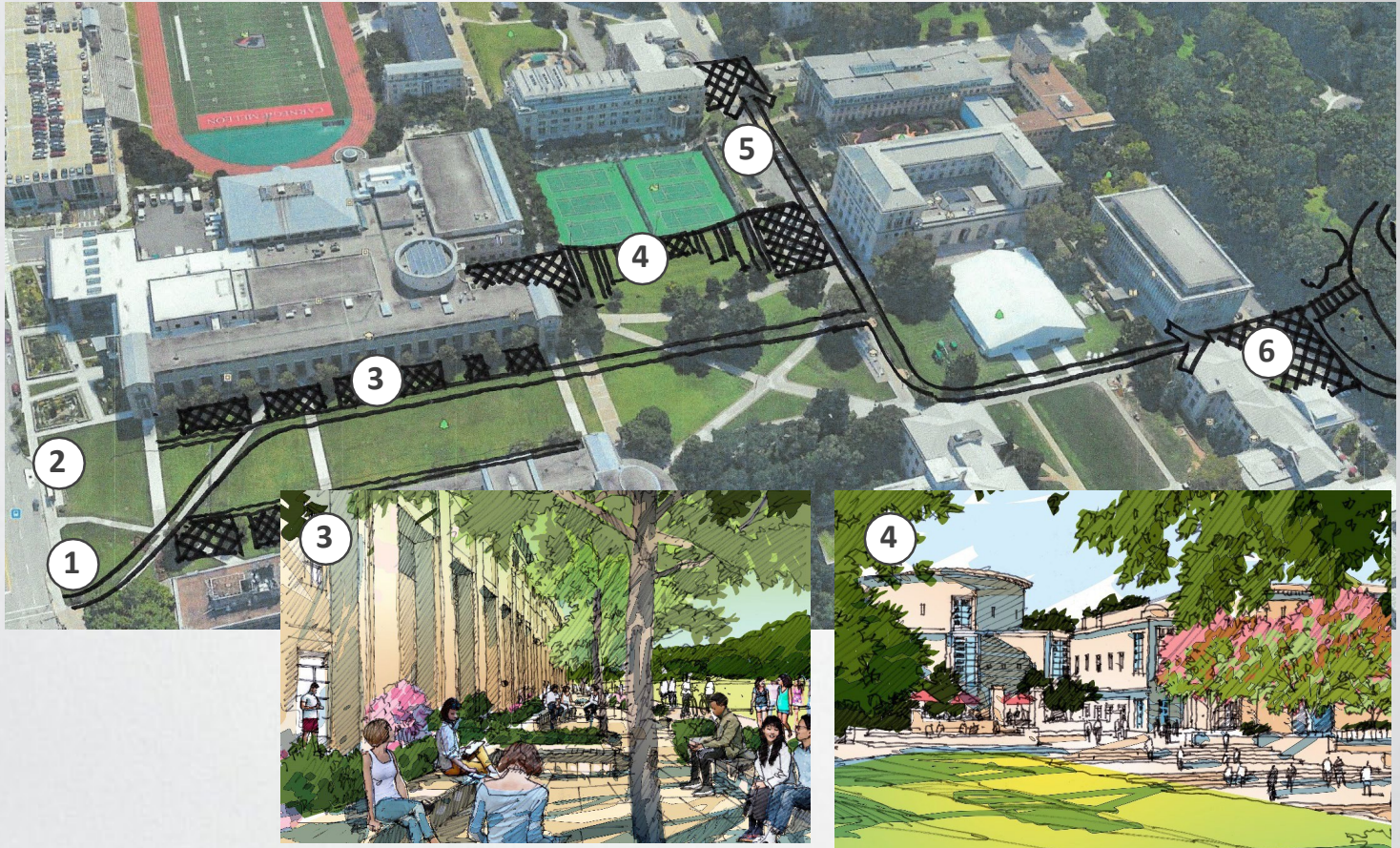

IMPROVE CONNECTIONS TO SCHENLEY PARK

- 1 Improved connection at New Scaife
- 2 New campus/park entrance plaza at Hunt Library
- 3 Hall of Arts entrance upgrades
- 4 New gateway at HWAC site on Tech St
- 5 Improve the parking layout to accommodate pedestrians and bikes

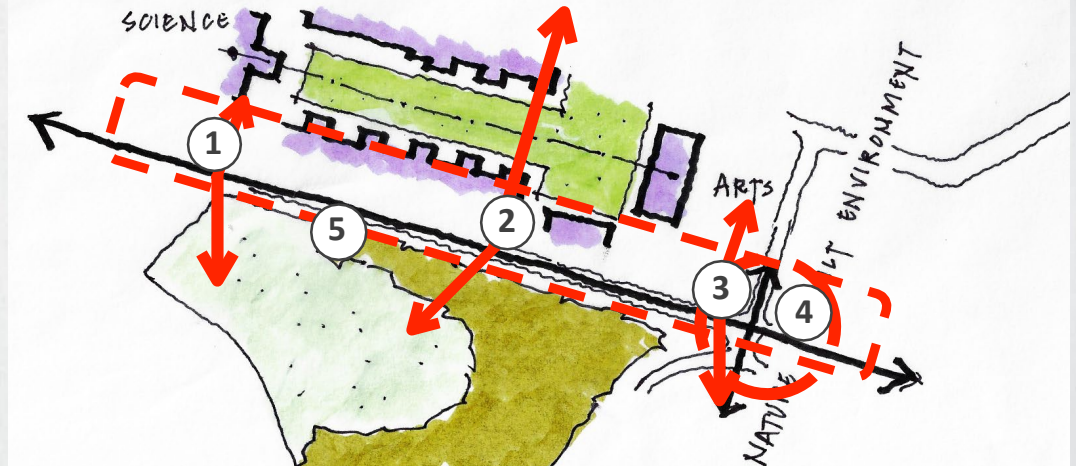

NEW CAMPUS CONNECTION TO SCHENLEY PARK

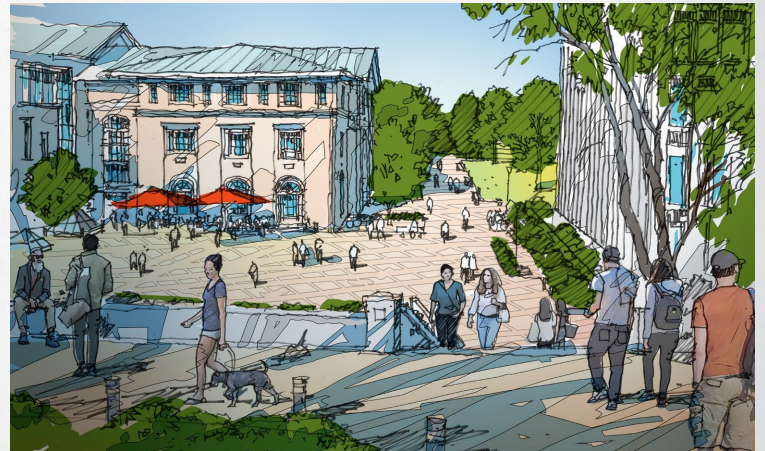
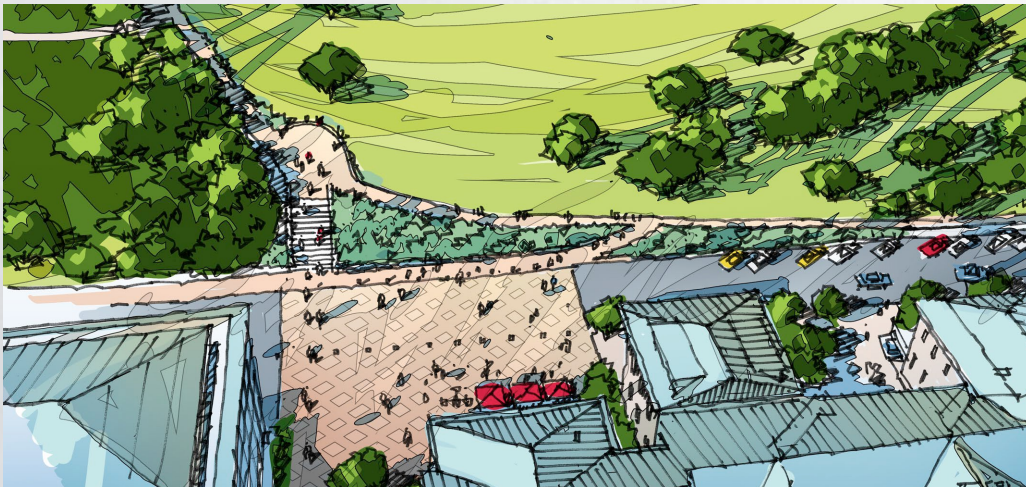

IMPROVE FREW-TECH-M.MORRISON CORRIDOR

- 1 Frew St Reconfiguration
- 2 New Pedestrian Crosswalks
- 3 Tech & Schenley Drive Improvements
- 4 Tech & M.Morrison Improvements
- 5 M.Morrison Improvements

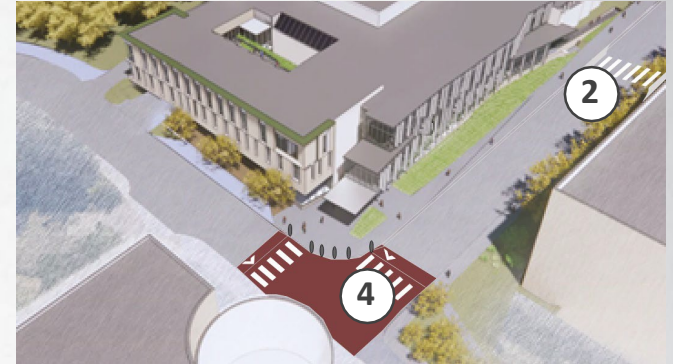

CREATE A CAMPUS BIKE NETWORK

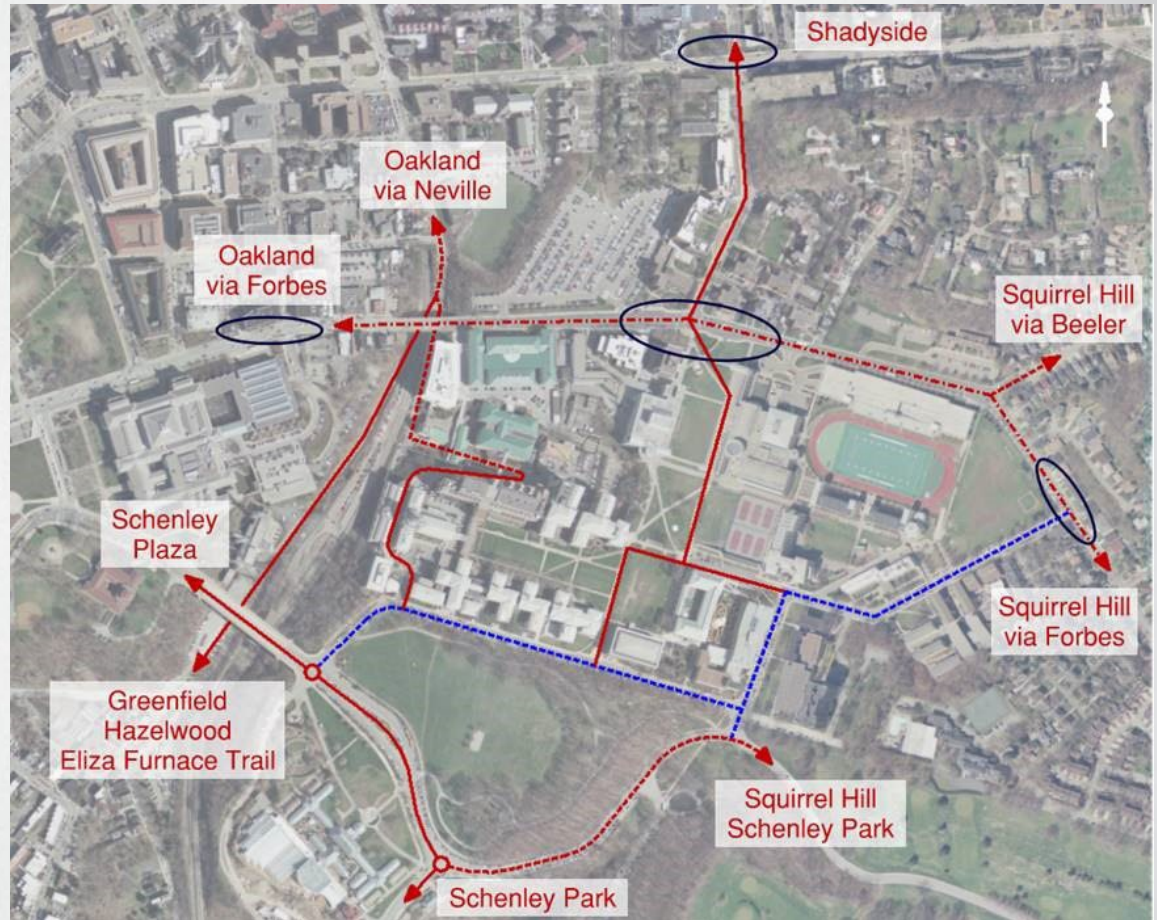

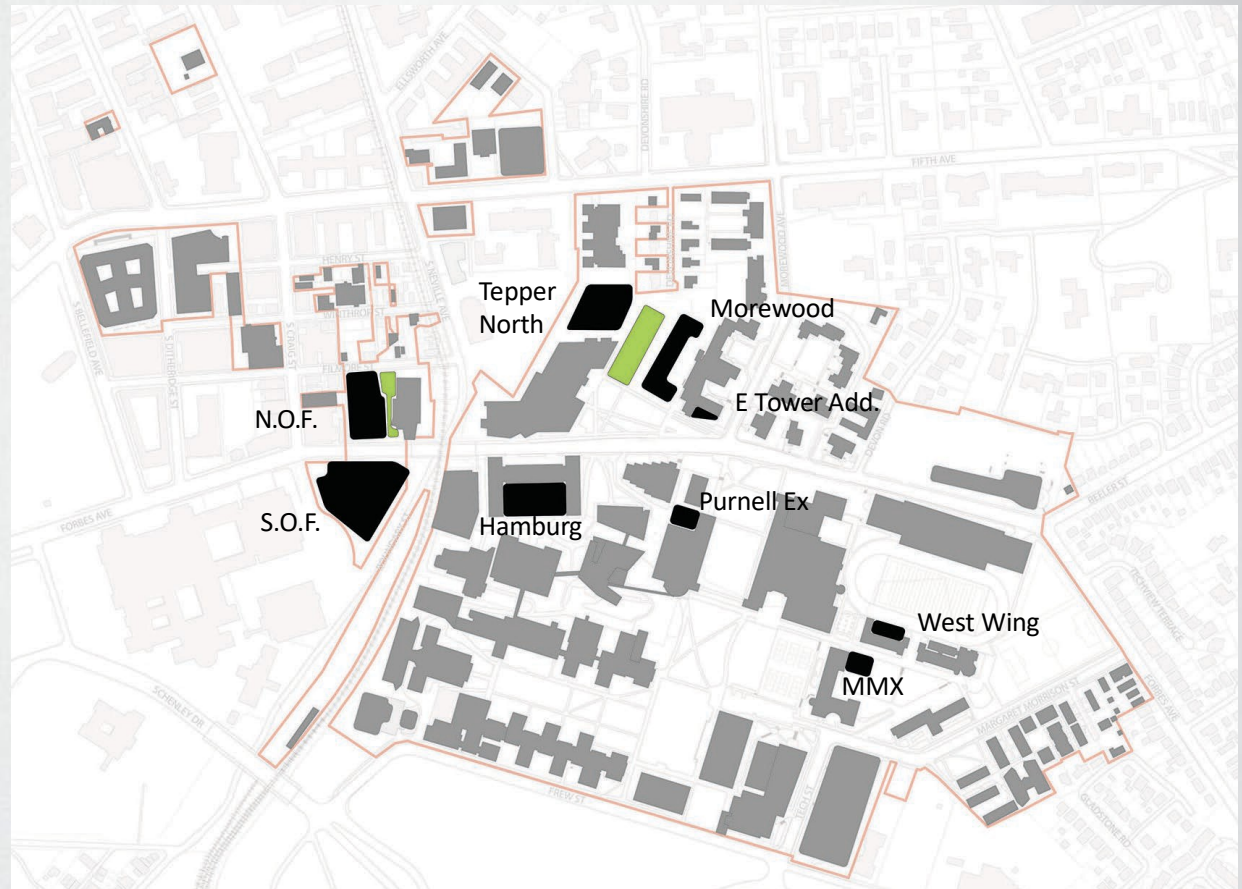

- Neighborway
- Shared Street
- Bike Lane
- Cycle Track
- BRT Station

SITES CARRIED OVER FROM 2012 IMP

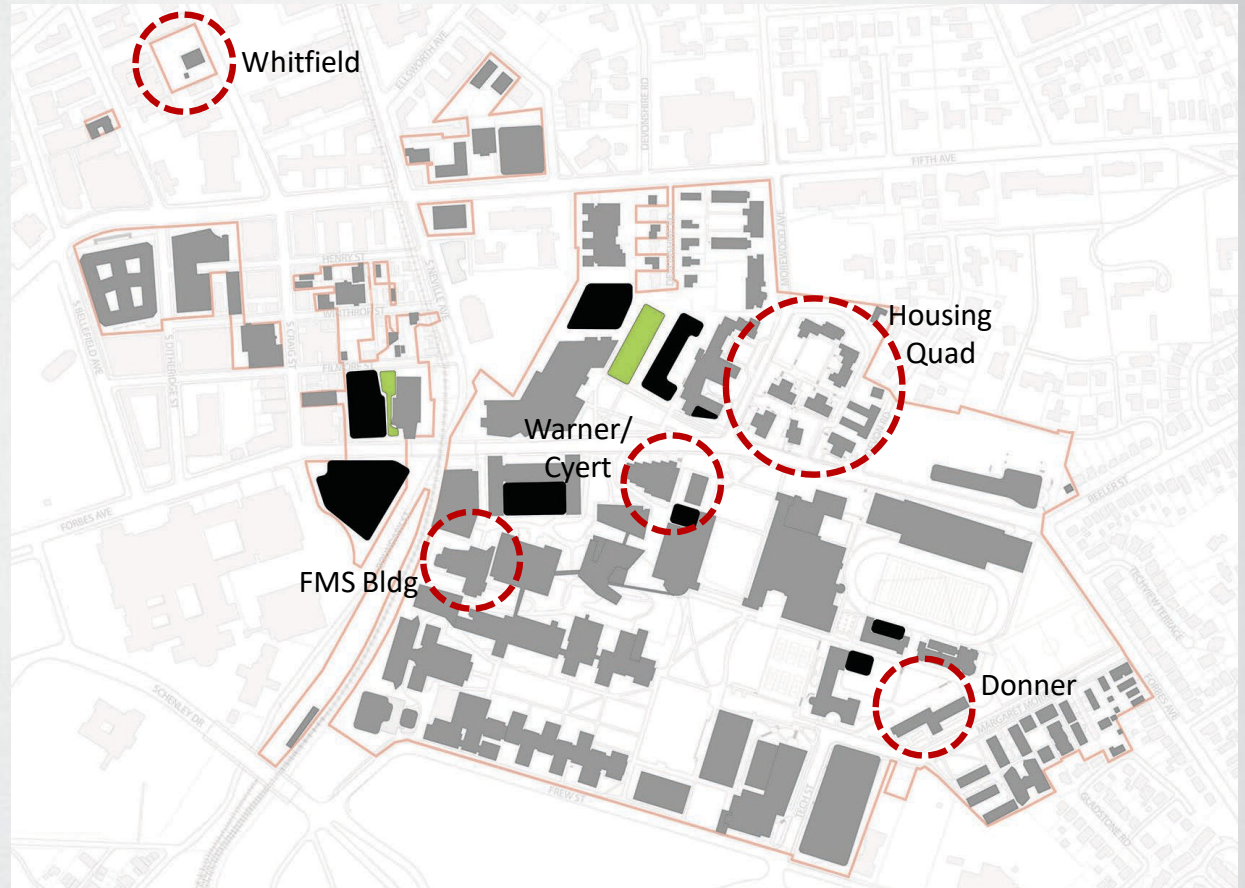

AREAS OF OPPORTUNITY

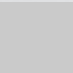

-  Remaining 2012 Sites
-  Existing Buildings

OUTREACH & APPROVAL SCHEDULE

← OUTREACH PHASE → ← APPROVAL PHASE →

		Introduction Phase				Draft Concepts			Final Document		Plan. Comm		City Council				
		2021												2022			
		Jan	Feb	Mar	Apr	May	Jun	Jul	Aug	Sep	Oct	Nov	Dec	Jan	Feb	Mar	Apr
CITY	City Council				↓	We are here											
	City Planning																
COMMUNITY	Public Meeting																
	Immediate Neighbors																
	Partner Institutions																
	Neighborhood Groups																
CAMPUS	Town Hall																
	Campus Groups																
	Design Review Com																
	Property & Facilities																
			outreach		updates		town hall		application		approval process						

THANK YOU!

- The next **Oakwatch** meeting is Wednesday, April 21 at 12:00 p.m. via Zoom
- Next **Oakland-Wide** Community Meeting is Tuesday, April 27 at 6:00 p.m. via Zoom and Facebook Live
- **Event calendar** – www.opdc.org/events
- Sign up for the **e-news** and meeting notices at www.opdc.org/contact-us
- **Social Media**
 - facebook.com/opdc.org
 - instagram.com/oaklandplanning
 - twitter.com/oaklandplanning
- **General inquiries** – questions@opdc.org